

# PLUG

INTENDED FOR USE WITH CLASS 200 OR 700  
COPPER NICKEL TUBE IAW MIL-T-16420

# SOCKET WELD

**SPECIFICATION: NAVSEA DWG 803-6397430**

**PRESSURE RATING: 400 PSIG (WOG)**

SERVICE RATING TABLE

Nominal Pipe Size (INCHES)	Maximum Working Pressure (LB/IN <sup>2</sup> )	Maximum Temperature (F°)	Maximum Working Pressure (LB/IN <sup>2</sup> )	Maximum Temperature (F°)
1/4 through 6	200	425	400	150
Above 6	150	425	250	150

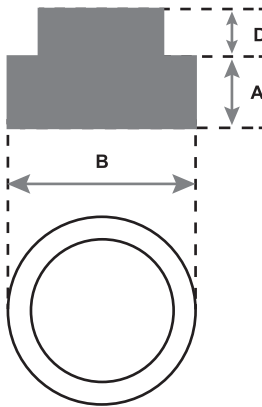

70/30 CUNI  
(ALLOY C715/C964)



90/10 CUNI  
(ALLOY C706/C962)

AVAILABLE ALLOYS: CUNI 90/10 & CUNI 70/30

NOMINAL PIPE SIZE	1/4	3/8	1/2	3/4	1	1 1/4	1 1/2	2	2 1/2	3	3 1/2	4
A	0.300 MIN - 0.410 MAX	0.340 MIN - 0.410 MAX	0.410 MIN - 0.540 MAX	0.440 MIN - 0.550 MAX	0.470 MIN - 0.690 MAX	0.530 MIN - 0.710 MAX	0.660 MIN - 0.730 MAX	0.690 MIN - 0.760 MAX	0.840 MIN - 1.070 MAX	0.890 MIN - 1.130 MAX	0.940 MIN - 1.100 MAX	0.970 MIN - 1.220 MAX
B	0.535 MIN - 0.540 MAX	0.670 MIN - 0.675 MAX	0.834 MIN - 0.840 MAX	1.044 MIN - 1.050 MAX	1.307 MIN - 1.315 MAX	1.652 MIN - 1.660 MAX	1.892 MIN - 1.900 MAX	2.365 MIN - 2.375 MAX	2.865 MIN - 8.75 MAX	3.488 MIN - 3.500 MAX	3.988 MIN - 4.000 MAX	4.485 MIN - 4.500 MAX
D	0.28 MIN	0.31 MIN	0.38 MIN	0.44 MIN	0.50 MIN	0.56 MIN	0.62 MIN	0.68 MIN	0.74 MIN	0.80 MIN	0.86 MIN	0.92 MIN

NOTES: Fittings may be ordered with reduced ends and/or female threads.

All sizes are in inches.