

# 45° ELBOW

INTENDED FOR USE WITH CLASS 200 OR 700  
COPPER NICKEL TUBE IAW MIL-T-16420

## SOCKET WELD

SPECIFICATION: NAVSEA DWG 803-6397430

PRESSURE RATING: 400 PSIG (WOG)

SERVICE RATING TABLE

Nominal Pipe Size (INCHES)	Maximum Working Pressure (LB/IN <sup>2</sup> )	Maximum Temperature (F°)	Maximum Working Pressure (LB/IN <sup>2</sup> )	Maximum Temperature (F°)
1/4 through 6	200	425	400	150
Above 6	150	425	250	150



90/10 CUNI  
(ALLOY C706/C962)



70/30 CUNI  
(ALLOY C715/C964)

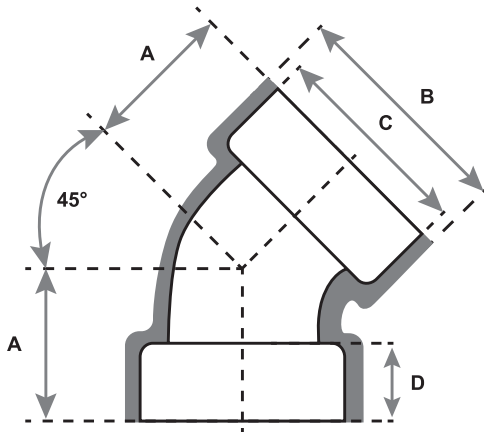

AVAILABLE ALLOYS: CUNI 90/10 & CUNI 70/30

NOMINAL PIPE SIZE	1/4	3/8	1/2	3/4	1	1 1/4	1 1/2	2	2 1/2	3	3 1/2	4
A	0.560	0.630	0.780	0.890	1.060	1.220	1.300	1.450	1.950	2.170	2.390	2.610
B	0.945	1.096	1.275	1.503	1.780	2.129	2.387	2.908	3.408	4.041	4.541	5.097
C	.545 (+/- .030)	.680 (+/- .030)	.845 (+/- .030)	1.055 (+/- .030)	1.320 (+/- .030)	1.665 (+/- .030)	1.905 (+/- .030)	2.380 (+/- .046)	2.880 (+/- .051)	3.505 (+/- .055)	4.005 (+/- .055)	4.505 (+/- .060)
D	25/94	5/16	3/8	13/32	7/16	1/2	5/8	23/35	25/32	77/93	7/8	29/32

NOTES: Fittings may be ordered with reduced ends and/or female threads.  
All sizes are in inches.