

MALE PIPE THREADED ADAPTER

SOCKET WELD

SPECIFICATION: NAVSEA DWG 803-6397430

PRESSURE RATING: 400 PSIG (WOG)

INTENDED FOR USE WITH CLASS 200 OR 700
COPPER NICKEL TUBE IAW MIL-T-16420

SERVICE RATING TABLE

Nominal Pipe Size (INCHES)	Maximum Working Pressure (LB/IN ²)	Maximum Temperature (F°)	Maximum Working Pressure (LB/IN ²)	Maximum Temperature (F°)
1/4 through 6	200	425	400	150
Above 6	150	425	250	150



70/30 CUNI
(ALLOY C715/C964)

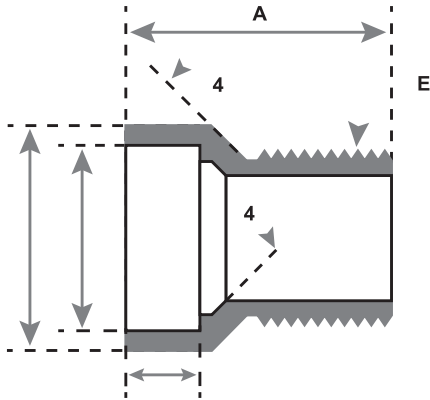

90/10 CUNI
(ALLOY C706/C962)

AVAILABLE ALLOYS: CUNI 90/10 & CUNI 70/30

NOMINAL PIPE SIZE	1/4	3/8	1/2	3/4	1	1 1/4	1 1/2	2
A	1.22 (+/- 0.08)	1.3 (+/- 0.10)	1.58 (+/- 0.12)	1.63 (+/- 0.12)	1.9 (+/- 0.14)	1.99 (+/- 0.14)	2.16 (+/- 0.16)	2.25 (+/- 0.16)
B	0.900 MIN. - 0.945 MAX.	1.051 MIN. - 1.096 MAX.	1.230 MIN. - 1.275 MAX.	1.458 MIN. - 1.503 MAX.	1.735 MIN. - 1.78 MAX.	2.084 MIN. - 2.129 MAX.	2.324 MIN. - 2.387 MAX.	2.863 MIN. - 2.908 MAX.
C	.545 (+/- .030)	.680 (+/- .030)	.845 (+/- .030)	1.055 (+/- .030)	1.320 (+/- .030)	1.665 (+/- .030)	1.905 (+/- .030)	2.380 (+/- .046)
D	25/94	5/16	3/8	13/32	7/16	1/2	5/8	23/35

NOTES: Fittings may be ordered with reduced ends and/or female threads.
All sizes are in inches.